

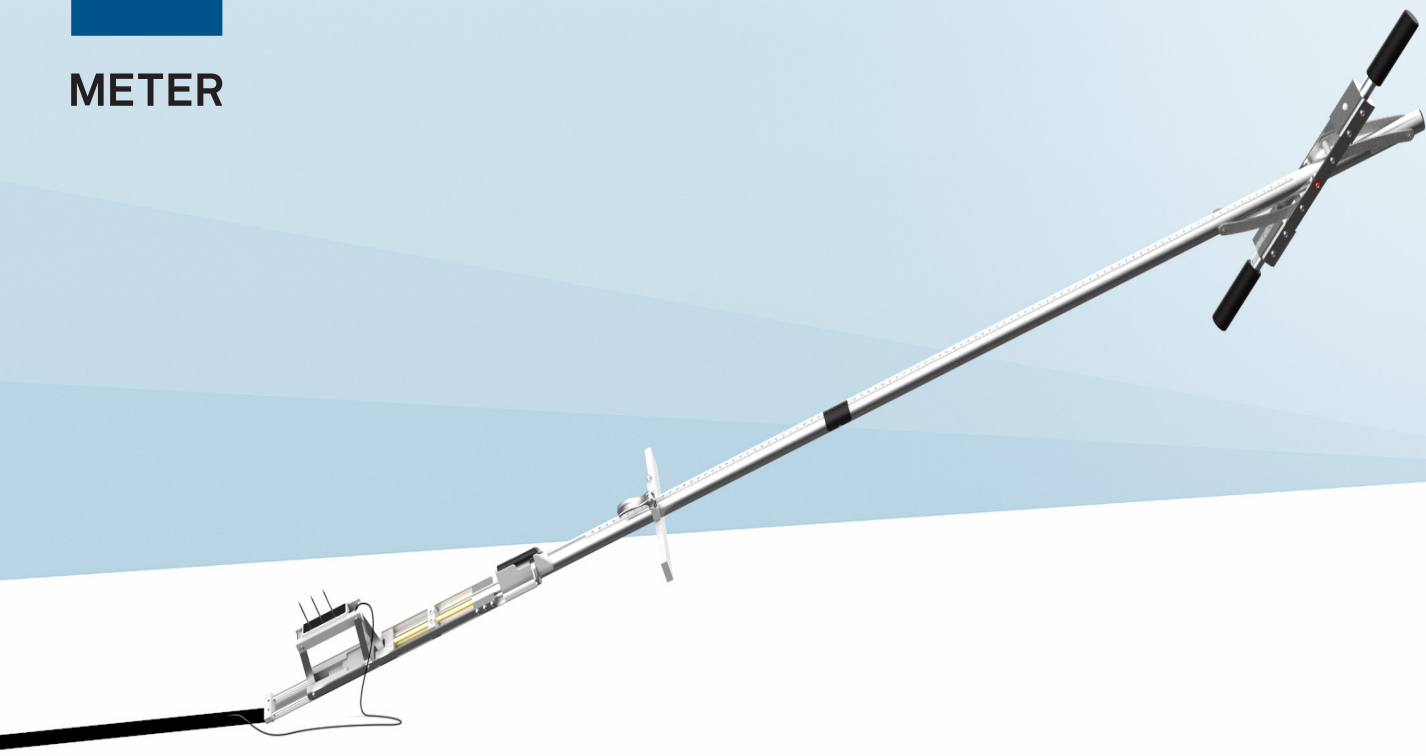

METER

TEROS BOREHOLE INSTALLATION TOOL ASSEMBLY INSTRUCTIONS



TEROS BIT ASSEMBLY INSTRUCTIONS

A. Handles	1. Hair pin
B. Base plate	2. Clevis pin (adjustable)
C. Middle clip (1.0 in)	3. Cam lever
D. Outer clip (1.25 in)	4. Lower inner rod
E. Screws	5. Lower middle sleeve
F. Lower assembly	6. Lower middle collar
G. Upper assembly	7. Stop
H. Flat-head screwdriver	8. Sensor carriage
I. Phillips®-head screwdriver	9. Lever
J. Crescent wrench	10. Upper inner rod
	11. Upper middle collar
	12. Upper outer sleeve

NOTE: The assembled TEROS BIT is more than 8 ft long. Find a suitable assembling area that is flat and large enough. A 4-in auger with handle and extensions is included to aid in sensor installation.

ATTACH UPPER INNER ROD + LOWER INNER ROD

1. Lay F and G as shown.
2. Move (9) on G to Upper position 1.
3. Move (8) on F to Upper position 1.
4. Align (4) and (12) so screw holes line up.
5. Insert E screws in each screw hole and tighten with I.

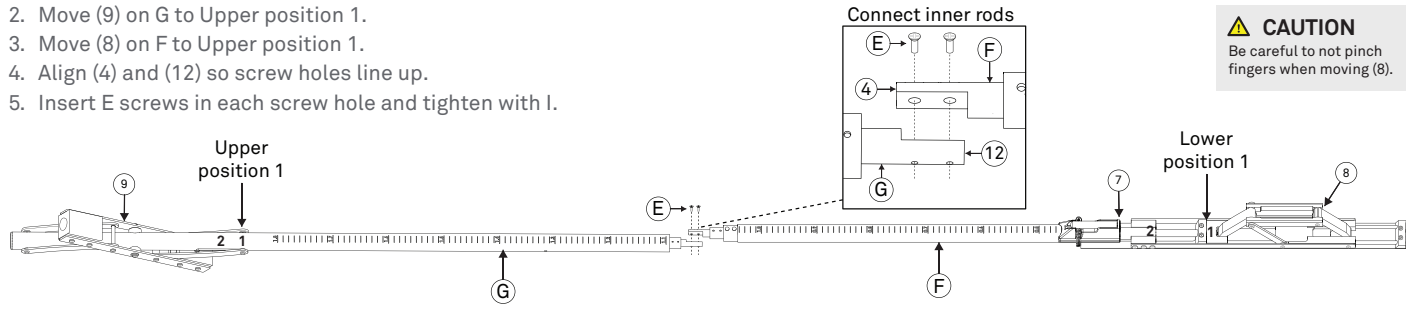

ATTACH UPPER MIDDLE SLEEVE + LOWER MIDDLE COLLAR

1. Move (9) on G to Upper position 2.
2. Move (8) on F to Lower position 2. Lower position 2 is when the inner rod is pushed all the way to (7); the sensor carriage will be in an extended position as shown.
3. Insert (5) into (11) and align holes. Some wiggling, twisting, and pushing may be necessary.
4. Insert C into holes of (5) and (11). Make sure clip is seated all the way.

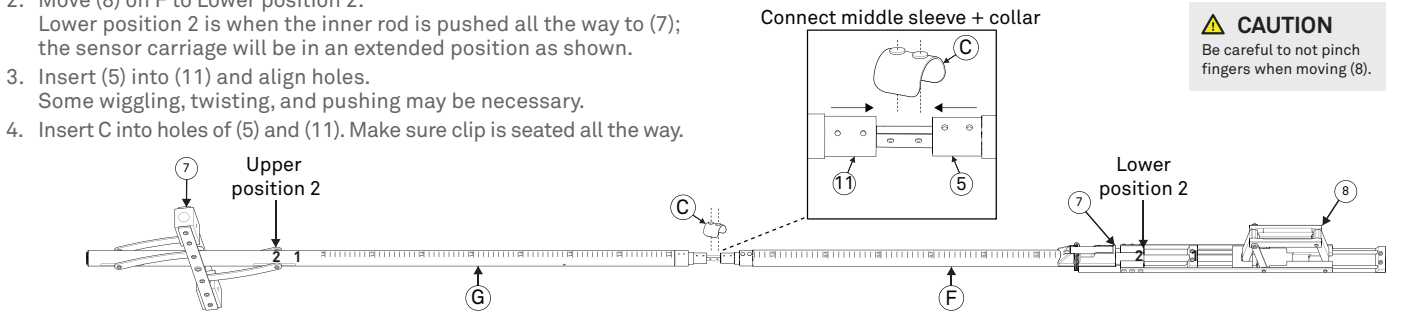

ATTACH OUTER SLEEVE + COLLAR

1. Rotate (9) on G and pull (6) until it slips over (10); align holes.
2. Install D into the holes of (6) and (10). Make sure clip is seated all the way.

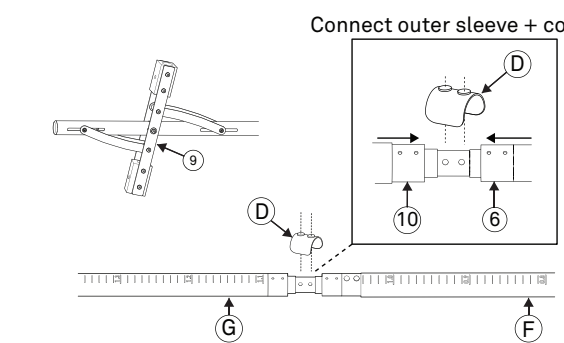

HANDLES + BASE PLATE

1. Insert A on (9). Insert (1) through hole in A and (9) and secure with (2).
2. Install B on F. Rotate top of B over F. Insert bolt and tighten. Leave the bolt a little loose so B can be moved up and down F.
3. Use (3) to adjust B when preparing for desired installation depth.

